

REVISIONS:

Do not heavily prune the tree at planting. Prune only cross-over limbs, co-dominant leaders, and broken or dead branches. Some interior twigs and lateral branches may be pruned, however, do NOT remove the terminal buds of branches that extend to the edge of the crown.

Trees less than 3" in caliper shall be staked with three stakes per tree, spaced evenly around the trunk with 12 gauge wire. Plastic hose sections shall be used at attachment to trees. Each wire shall be flagged with a visual marker. 5' long min. wooden stakes shall be used to anchor the wires. Stakes shall be driven at least 12" outside the edge of the planting pit into stable soil. Remove all staking NO LATER than the end of the first growing season after planting.

Mark the north side of the tree in the nursery. Rotate the tree to face north at the site whenever possible.

4 in. high earth saucer beyond edge of root ball

2 in. max. Mulch. Do NOT place mulch in contact with tree trunk. Maintain the mulch weed-free for a minimum of three years after planting.

Tamp soil around root ball base firmly with foot pressure so that root ball does not shift.

Place root ball on unexcavated or tamped soil.

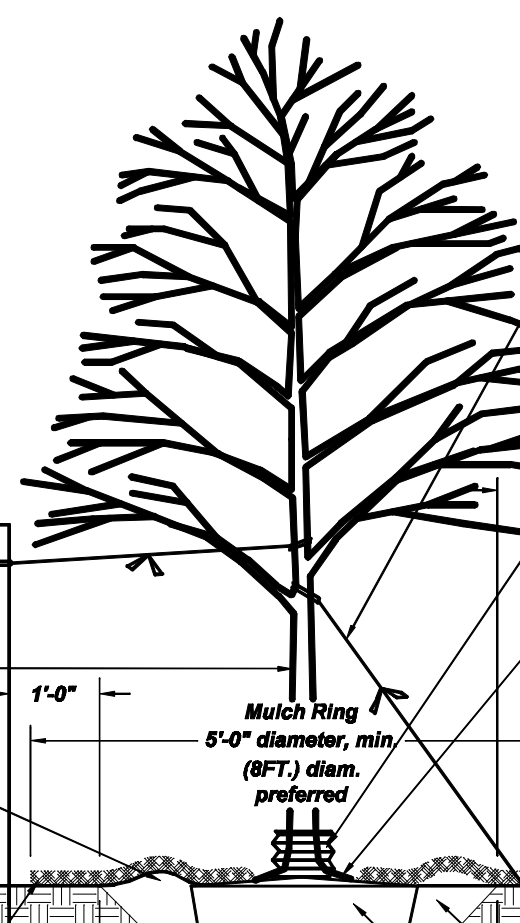

Trees greater than 3" in caliper shall be guyed with three guys per tree, spaced evenly around the trunk with 12 gauge wire. Plastic hose sections shall be used at attachment to trees. Each guy wire shall be flagged with a visual marker. 24" stakes or metal drive anchors shall be used to anchor the guy wires. Stakes/Anchors shall be driven 12" min. outside the edge of the planting pit into stable soil. Remove all guying NO LATER than the end of the first growing season after planting.

6" Corrugated PVC tree sock

Each tree must be planted such that the original trunk flare is visible at the top of the root ball. Trees where the original trunk flare is not visible may be rejected. Do NOT cover the top of the root ball with soil. Before planting Contractor shall inspect the rootball for the location of the original root flare. If the original root flare is not visible at the top of the root ball then the Contractor shall then gently remove from the top of the root ball any excess soil from nursery operations that may be covering the original root flare. All secondary and girdling roots shall be removed prior to planting. Trees with 4" or more of extraneous soil and/or adventitious roots greater than 1/8" shall be rejected. The tree shall be planted with the original root flare at or slightly (2-3") above surrounding finished grade.

Backfill with existing soil. In sandy and heavy clay soils add 20% max. by volume composted organic material to the existing soil.

Remove all twine, rope, wire, and burlap from top half of root ball

If plant is shipped with a wire basket around the root ball, prior to planting, the contractor shall cut away the bottom of the wire basket, leaving the sides in place. Once the tree is placed and faced, the contractor shall remove the remainder of the wire basket and backfill the planting pit as noted above.

Typical Tree Planting Detail

Scale: NTS

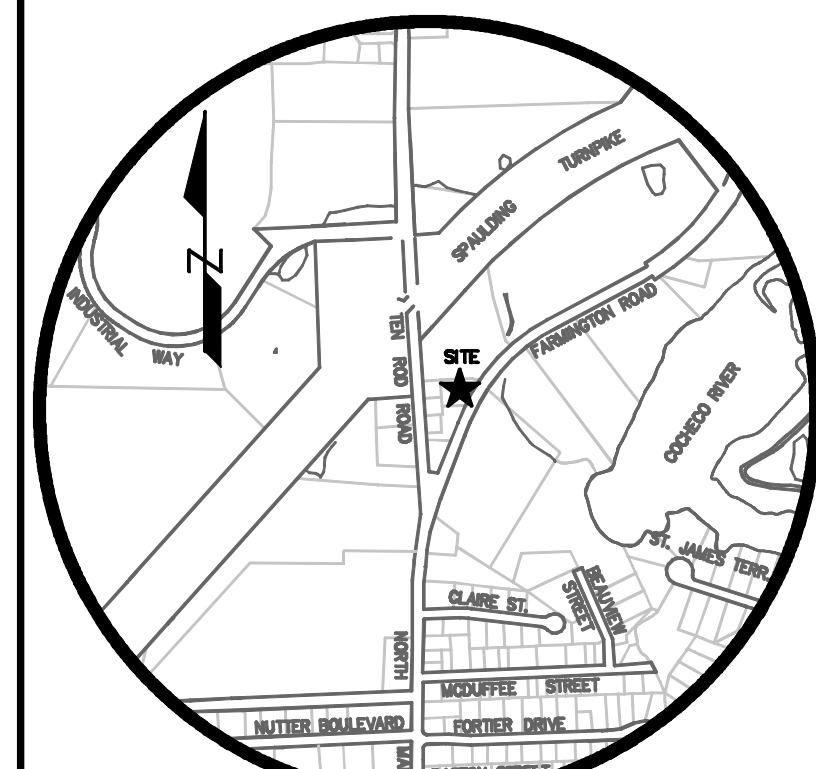

LOCUS
SCALE: 1"=1000'

FILE NO. 141 DRAWN BY: RRL
PLAN NO. C-2604 CHK'D BY: DBR
F.B. NO. ### SCRD NO: D-###
DWG. NO. 11107/SP-1CRLSN

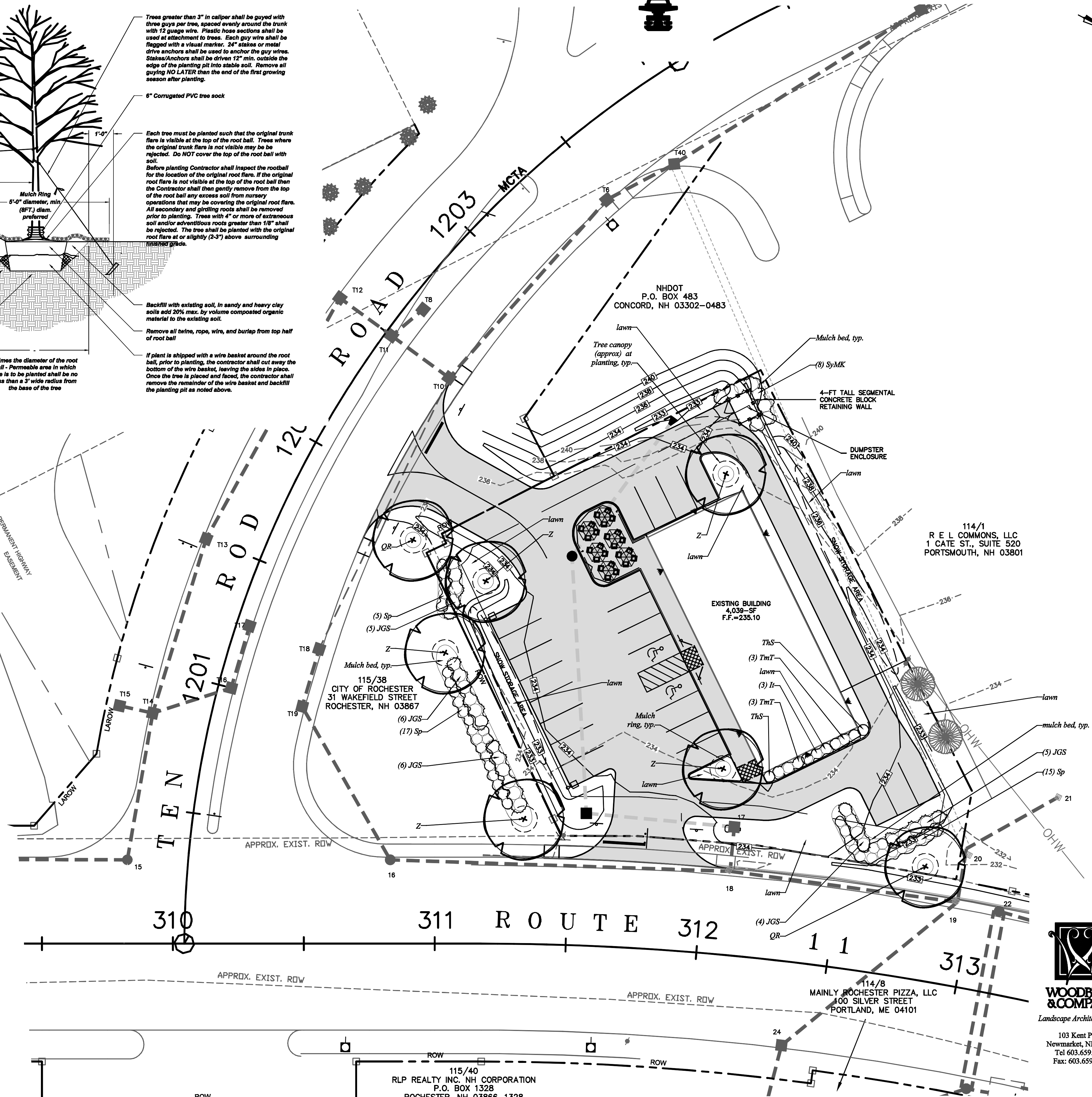
**Plant List****TREES**

Symbol	Botanical Name	Common Name	Quantity	Size	Comments
QR	Quercus rubra	Red Oak	2	2-2.5' cal	
Z	Zelkova serrata 'Green Vase'	Green Vase Zelkova	5	2-2.5' cal	

SHRUBS

Symbol	Botanical Name	Common Name	Quantity	Size	Comments
T	Ilex virginica 'Little Henry'	Little Henry Sweetgum	3	5 gal	
GS	Gaultheria procumbens 'Gold Star'	Gold Star Wintergreen	16	16-24"	
Sp	Spiraea x bumalda 'Fireball'	Fireball Spirea	37	2-2.5' B&B	
SYM	Syringa x amurensis 'Munich'	Munich Lilac	4	3-4' B&B	
ThS	Thunbergia occidentalis 'Shangri'	Emerald Green Abutilon	2	4-5' B&B	
TmT	Taxus media 'Tardiff'	Tardiff Yew	6	2-2.5' B&B	

Landscape Notes

- Design is based on drawings by Norway Plains Associates received 2011-12-07 and may require adjustment due to actual field conditions.
- The contractor shall follow best management practices during construction and shall take all means necessary to stabilize and protect the site from erosion.
- Erosion Control shall be in place prior to construction.
- Erosion Control to consist of Hay Bale and Erosion Control Fabric shall be staked in place between the work and Water bodies, Wetlands and/or drainage ways prior to any construction.
- The Contractor shall verify layout and grades and inform the Landscape Architect or Client's Representative of any discrepancies or changes in layout and/or grade relationships prior to construction.
- Trees to remain within the construction zone shall be protected from damage for the duration of the project by snow fence or other suitable means of protection to be approved by Landscape Architect or Client's Representative. Snow fence shall be located at the drip line at a minimum and shall include any and all surface roots. Do not fill or mulch on the trunk flare. Do not disturb roots. In order to protect the integrity of the roots, branches, trunk and bark of the tree(s) no vehicles or construction equipment shall drive or park in or on the area within the drip line(s) of the tree(s). Do not store any refuse or construction materials or portable within the tree protection area.
- This plan is for review purposes only, NOT for Construction. Construction Documents will be provided upon request.
- Location, support, protection, and restoration of all existing utilities and appurtenances shall be the responsibility of the Contractor.
- The Contractor shall verify exact location and elevation of all utilities with the respective utility owners prior to construction. Call 800-451-1234 at 1-888-544-7233.
- The Contractor shall procure any required permits prior to construction.
- Prior to any landscape construction activities Contractor shall test all existing loam and loam from off-site intended to be used for lawns and plant beds using a thorough sampling throughout the supply. Soil testing shall indicate levels of pH, nitrate, macro and micro nutrients, texture, soluble salts, and organic matter. Contractor shall provide Landscape Architect with test results and recommendations from the testing facility along with soil amendment plans as necessary for the proposed plantings to thrive. All loam to be used on site shall be amended as approved by the Landscape Architect prior to placement.
- The Contractor shall furnish and plant all plants shown on the drawings and listed thereon. All plants shall be nursery-grown under climatic conditions similar to those in the locality of the project. Plants shall conform to the botanical name and standards of size, culture, and quality for the highest grades and standards as adopted by the American Association of Nurserymen, Inc. in the American Standard Nursery Stock, American Standards Institute, Inc. 230 Southern Building, Washington, D.C. 20005.
- A complete list of plants, including a schedule of sizes, quantities, and other requirements is shown on the drawings. In the event that quantity discrepancies or material omissions occur in the plant materials list, the planting plans shall govern.
- All plants shall be lightly tagged with proper botanical name.
- The Contractor shall guarantee all plants for not less than one year from date of acceptance.
- Owner or Owner's Representative will inspect plants upon delivery for conformity to Specification requirements. Such approval shall not affect the right of inspection and rejection during or after the progress of the work. The Owner reserves the right to inspect and/or select all trees at the place of growth and reserves the right to approve a representative sample of each type of shrub, herbaceous perennial, annual, and ground cover at the place of growth. Such sample will serve as a minimum standard for all plants of the same species used in the work.
- No substitutions of plants may be made without prior approval of the Owner or the Owner's Representative for any reason.
- All landscaping shall be provided with either of the following:
 - An underground sprinkling system
 - An outside hose attachment within 150 feet
- If an automatic irrigation system is installed, all irrigation valve boxes shall be located within planting bed areas.
- Contractor shall provide an alternate price for irrigating all newly landscaped areas. Contractor shall provide irrigation design for review by Landscape Architect or Owner's Representative when awarded the project.
- All disturbed areas will be dressed with 2" of topsoil and planted as noted on the plans or seeded except plant beds. Plant beds shall be prepared to a depth of 12" with 75% loam and 25% compost.
- Trees, ground cover, and shrub beds shall be mulched to a depth of 2" with one-year-old, well-composted, shredded native bark not longer than 4" in length and 1/2" in width, free of woodchips and sawdust. Mulch for ferns and herbaceous perennials shall be no longer than 1" in length. Trees in lawn areas shall be mulched in a 5' diameter min. saucer. Color of mulch shall be black.
- In no case shall mulch touch the stem of a plant nor shall mulch ever be more than 3" thick total (including previously applied mulch) over the root ball of any plant.
- Areas designated as LAWN shall be mowed regularly.
- Owner is solely responsible for maintaining vehicular and pedestrian vision lines pertaining to vegetation growth.
- Secondary lateral branches of deciduous trees overhanging vehicular and pedestrian travel ways shall be pruned up to a height of 7' to allow clear and safe passage of vehicles and pedestrians under tree canopy.
- Show what is to be stored a minimum of 5' from shrubs and trunks of trees.
- Landscape Architect is not responsible for the means and methods of the contractor.

LANDSCAPE PLAN

ROUTE 11/TEN ROD ROAD
ROCHESTER, NH
STRAFFORD COUNTY
FOR
ROCHESTERDOM, LLC

NOVEMBER 2011

GRAPHIC SCALE

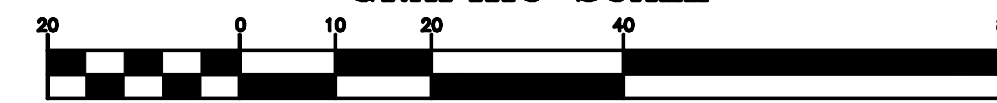

(IN FEET)

1 INCH = 20 FT.

REVISION DATE

2011-12-12

SHEET L-1