

**HISTORIC PRESERVATION PROGRAM - STRAFFORD ROCKINGHAM REGIONAL COUNCIL**  
One Water Street, Exeter, New Hampshire 03833 Phone: (603)778-0885

TOWN: Rochester	COUNTY: Strafford	UTM: Z 19 /E339750 /N4796250
SURVEY NUMBER: 52		USGS QUAD: Berwick Quad 15' series
COMMON NAME: First United Methodist Church		FUNCTIONAL TYPE: Church
HISTORIC NAME: Christ Episcopal Church		PRESENT USE: Church
LOCATION: South Main Street		ARCHITECT/BUILDER: Unknown
OWNER: First Methodist Church		CONDITION: Exc. <input checked="" type="checkbox"/> Good <input type="checkbox"/> Fair <input type="checkbox"/> Poor <input type="checkbox"/> Ruins <input type="checkbox"/>
ADDRESS: S. Main ST., Rochester, NH 03867		INTEGRITY: Original Site <input checked="" type="checkbox"/> Moved <input type="checkbox"/> Date _____
MAP & PARCEL # : 51/190 120-364		Major Alterations & Date: _____
DATE: C. 1868		
SOURCE: Date Plaque		
STYLE: Italianate		LEVEL/SIGNIFICANCE: Natl. <input type="checkbox"/> State <input type="checkbox"/> Local <input checked="" type="checkbox"/>

**GENERAL DESCRIPTION: Structural System**

- # Stories 2 # Bays 3 X 4 Approx. Dimensions 50' X 100' Window Sash multi paned  
Roof Style: Gable ☒ Hip ☐ Gambrel ☐ Flat ☐ Shed ☐ Mansard ☐ Jerkinhead ☐  
Monitor ☐ Sawtooth ☐ Other ☐  
Appendages: Porches ☐ Towers ☒ Dormers ☐ Bay Windows ☐ Ells ☐ Chimneys ☐  
Wings ☒ Cupolas ☐ Sheds ☐ Garage ☐ Other ☒ spire  
Entry Location: Center ☒ Sidehall ☐ Other ☐
- FOUNDATION: Random Rubble ☐ Cut Granite ☒ Brick ☐ Concrete ☐ Concrete Block ☐  
Other ☐
- WALL STRUCTURE:  
Wood Frame: Post & Beam ☒ Balloon Frame ☐ Other ☐  
Load Bearing Masonry: Stone ☐ Brick ☒ Concrete Block ☐ Other ☐  
Metal: Iron ☐ Steel ☐ Other ☐
- WALL COVERING: Clapboard ☐ Wood Shingle ☐ Board & Batten ☐ Shiplap ☐  
Aluminum ☐ Novelty ☐ Stucco ☐ Stone ☐ Brick ☒ Sheet Metal ☐ Asphalt Shingles ☐  
Vinyl ☐ Asphalt Sheeting ☐ Composite Board ☐ Other ☐
- ROOF SHEATHING: Wood Shingle ☐ Asphalt Shingle ☐ Standing Seam Tin ☐ Slate ☒  
Pressed Metal ☐ Sheet Metal ☐ Rolled Asphalt ☐ Gravel ☐ Other ☐
- ENGINEERING STRUCTURE:

MAP (Indicate North in circle):

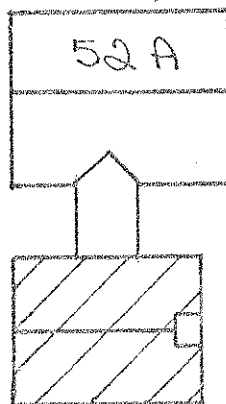

MAIN STREET

PHOTO

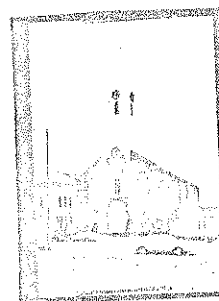

Description of View: Three Quarter  
looking north east  
Negative File Number: R-80-A4-9  
Photographer:  
Negative on file with: SRRC

## ADDITIONAL ARCHITECTURAL AND STRUCTURAL DESCRIPTION:

The First United Methodist Church is a gable-roofed, axial-plan brick building oriented gable end to the street. Constructed in the Italianate style, it features round-headed windows, a steeple centered over the facade, and ornamental brickwork. The corners of the building are highlighted by brick piers, and arched corbelling encircles the roofline.

The symmetrical facade is divided into 3 bays by brick piers. In the side bays, round-headed, paired 8/8 windows are contained within round arches topped by brick hood molds. The central bay features a rectangular stained glass window and rosette window within a single arch, also having a brick hood mold. A date plaque is centered over this window.

The entrance is centered on the facade, containing the original round-headed doors in a molded frame.

## RELATED STRUCTURES AND CONTEXT:

The church is located just south of Central Square, adjacent to the business district.

## STATEMENT OF SIGNIFICANCE (Evaluation & Historical Associations):

The Methodist Church was built C.1868 from bricks produced locally in Genoa. Architecturally it is an ornate example of the Italianate Style, characterized by round-headed windows, arched brick corbeling and a tall shingled spire.

## REFERENCES:

Rochester History Advisory Committee

MAP DATA: 1871-Methodist Church 1877-1884-Birds Eye Views 1892- Sanborn

SURROUNDING ENVIRONMENT: Open Land\_\_\_Woodland\_\_\_Scattered Bldgs\_\_\_Moderately Built Up\_\_\_  
Densely Built Up\_\_\_Residential\_\_\_Commercial\_\_\_Industrial\_\_\_Agricultural\_\_\_  
Roadside Strip Development\_\_\_Other\_\_\_

BOUNDARY AND ACREAGE DESCRIPTION: (LOT SIZE) 105 X 229

Recorded By: Roger Brevoort

Date: 11/19/80

HISTORIC PRESERVATION ASSISTANCE PROJECT

Strafford Rockingham Regional Council

1 Water Street, Exeter, New Hampshire

Phone: (603) 778-0885

Continuation Sheet

Description

A multi-stage tower rises from the central bay. Its square base is articulated by corner pilasters and has a projecting cornice. The upper section consists of an octagonal shaft with loovers and clock faces on four sides, and has an octagonal wood-shingled spire highlighted by bands of sawtooth shingles.

The five bays on the side elevations are also delineated by brick piers. The 4 rear bays contain paired multi-pane windows topped by lunettes, all set within Half-round arches.

Slate sheathing, the historically appropriate material, remains on the roof.

