

Strafford Rockingham Regional Council

1 Water Street, Exeter, New Hampshire

Phone: (603) 778-0885

TOWN: Rochester	COUNTY: Strafford	UTM: Z 19 /E 339 765 /N 4796 315
SURVEY NUMBER: 47		USGS QUAD: Berwick Quad 15' series
COMMON NAME: The Foss and Came Agency		FUNCTIONAL TYPE: Commercial
HISTORIC NAME: Unknown		PRESENT USE: Commercial
LOCATION: 7 Hanson Street		ARCHITECT/BUILDER: Unknown
OWNER: James L. Foss		CONDITION: Exc. <input checked="" type="checkbox"/> Good <input checked="" type="checkbox"/> Fair <input type="checkbox"/> Poor <input type="checkbox"/> Ruins <input type="checkbox"/>
ADDRESS: 7 Hanson St., Rochester, NH 03867		INTEGRITY: Original Site <input checked="" type="checkbox"/> Moved <input type="checkbox"/> (When: <input type="text"/> )
MAP & PARCEL #: 51/203 120-390		Major alterations & date: <input type="text"/>
DATE: C. 1855		Storefront altered <input type="text"/>
SOURCE: Inspection		LEVEL/SIGNIFICANCE: Natl <input type="checkbox"/> State <input type="checkbox"/> Local <input checked="" type="checkbox"/>
STYLE: Italianate		

GENERAL DESCRIPTION: Structural System

- FOUNDATION: Stone ☐ Brick ☒ Concrete ☐ Concrete Block ☐
- WALL STRUCTURE: Wood Frame ☐ Post & Beam ☐ Ballon Frame ☒ Other ☐  
Load Bearing Masonry ☐ Stone ☐ Brick ☐ Concrete Block ☐ Other ☐  
Metal ☐ Iron ☐ Steel ☐ Other ☐
- WALL COVERING: Clapboard ☒ Wood Shingle ☐ Board & Batten ☐ Shiplap ☐ Aluminum ☐  
Novelty ☐ Stucco ☐ Stone ☐ Brick ☐ Sheet Metal ☐ Asphalt Shingles ☐ Vinyl ☐  
Asphalt Sheeting ☐ Composite Board ☐ Other ☐
- ROOF SHEATHING: Wood Shingle ☐ Asphalt Shingle ☒ Standing Seam Tin ☐ Slate ☐  
Pressed Metal ☐ Sheet Metal ☐ Rolled Asphalt ☐ Other ☐
- ENGINEERING STRUCTURE:
- OTHER: 3 X 3  
# of Stories 2 1/2 # of Bays  Approx. Dimensions 30' X 40'  
Roof Style: Gable ☒ Hip ☐ Gambrel ☐ Flat ☐ Shed ☐ Mansard ☐ Jerkinhead ☐  
Monitor ☐ Sawtooth ☐ Other ☐  
Appendages: Porches ☐ Towers ☐ Dormers ☐ Bay Windows ☐ Ells ☒ Chimneys ☐  
Wings ☐ Cupolas ☐ Sheds ☐ Garage ☐ Other ☐  
Entry Location: Center ☐ Sidehall ☐ Other ☐

MAP (Indicate North in circle):

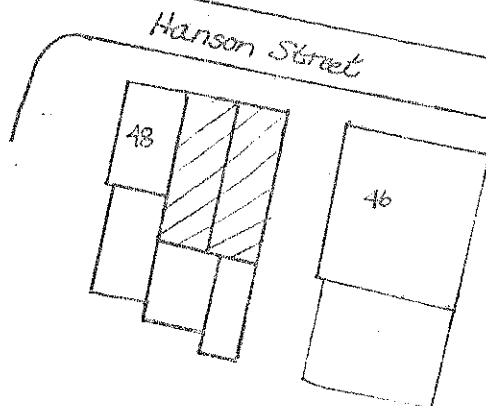
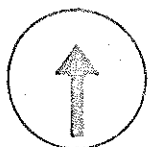

PHOTO



Description of View: Facade, looking southwest

Photographer: Roger Brevoort  
Negative with: S.R.R.C.

Negative File Number: R-81-A4-5

## ADDITIONAL ARCHITECTURAL AND STRUCTURAL DESCRIPTION:

Placed gable end to the street, this is a 2½ story, 3 bay wide Italianate building which appears to have been constructed as a residence. The upper stories still retain original details, including arched window hoods over the segmentally-arched 1/1 sash, and paired brackets supporting the box cornice on the facade and side elevations.

On the second story, the center bay features a paired window, and within the gable end is a window with a unique 3-lobed design.

The facade was originally flanked by wide pilasters. Only the upper portion of the pilasters remain due to extensive remodeling of the first story to accomodate a commercial storefront.

## RELATED STRUCTURES AND CONTEXT:

The building is at the western end of the nineteenth century commercial street -- scape on the south side of Hanson Street.

## BOUNDARY AND ACREAGE DESCRIPTION: (LOT SIZE) 30 X 70

## REFERENCES:

Rochester History Advisory Committee

MAP DATA 1892-Atlas-D. Hanson 1892- Sanborn Map- Furniture & Photo

## STATEMENT OF SIGNIFICANCE (Evaluation & Historical Associations):

This is one of two houses that reflect the original residential character of Hanson Street. Built c. 1855-60 in the Italianate style it retains its architectural identity because of the upper story details which are characteristic of Italianate architecture.

Previous twentieth century uses included Steven's Photography Studio, there was also a photographers studio here during the later nineteenth century, and a millinery shop.

SURROUNDING ENVIRONMENT: Open Land ☐ Woodland ☐ Scattered Bldgs ☐ Moderately Built Up ☐  
Densely Built Up ☐ Residential ☐ Commercial ☐ Industrial ☐ Agricultural ☐  
Roadside Strip Development ☐ Other ☐

Recorded By:

Roger Brevoort

Date: 11/16/80

# HISTORIC PRESERVATION ASSISTANCE PROJECT

Strafford Rockingham Regional Council

1 Water Street, Exeter, New Hampshire

Phone: (603) 778-0885

TOWN: Rochester	COUNTY: Strafford	UTM: Z19 /E 339750 /N 4796300
SURVEY NUMBER: 48		USGS QUAD: Berwick Quad 15' series
COMMON NAME: Meader's Office Supply		FUNCTIONAL TYPE: Commercial
HISTORIC NAME: Rochester Post Office		PRESENT USE: Commercial
LOCATION: 5 Hanson Street		ARCHITECT/BUILDER: Unknown
OWNER: John R. Douglas		CONDITION: Exc. Good Fair <input checked="" type="checkbox"/> Poor Ruins
ADDRESS: 14 Academy St., Rochester, NH		INTEGRITY: Original Site <input checked="" type="checkbox"/> Moved (When: )
MAP & PARCEL #: 51/204 120-390		Major alterations & date: New facade
DATE: c.1869		
SOURCE: Gladys Redlon notes		
STYLE: Victorian Commercial		LEVEL/SIGNIFICANCE: Natl State Local <input checked="" type="checkbox"/>

## GENERAL DESCRIPTION: Structural System

1. FOUNDATION: Stone ☐ Brick ☐ Concrete ☐ Concrete Block ☐ Cut Granite ☐
2. WALL STRUCTURE: Wood Frame ☐ Post & Beam ☐ Ballon Frame ☒ Other ☐  
Load Bearing Masonry ☐ Stone ☐ Brick ☐ Concrete Block ☐ Other ☐  
Metal ☐ Iron ☐ Steel ☐ Other ☐
3. WALL COVERING: Clapboard ☒ Wood Shingle ☐ Board & Batten ☐ Shiplap ☐ Aluminum ☐  
Novelty ☐ Stucco ☐ Stone ☐ Brick ☐ Sheet Metal ☐ Asphalt Shingles ☐ Vinyl ☐  
Asphalt Sheeting ☐ Composite Board ☐ Other ☒ Vertical Boarding-Facade ☐
4. ROOF SHEATHING: Wood Shingle ☐ Asphalt Shingle ☒ Standing Seam Tin ☐ Slate ☐  
Pressed Metal ☐ Sheet Metal ☐ Rolled Asphalt ☐ Other ☐
5. ENGINEERING STRUCTURE:
6. OTHER:  
# of Stories 1 # of Bays 3X0 Approx. Dimensions 20' X 35'  
Roof Style: Gable ☐ Hip ☐ Gambrel ☐ Flat ☐ Shed ☒ Mansard ☐ Jerkinhead ☐  
Monitor ☐ Sawtooth ☐ Other ☐  
Appendages: Porches ☐ Towers ☐ Dormers ☐ Bay Windows ☐ Ells ☒ Chimneys ☒  
Wings ☐ Cupolas ☐ Sheds ☐ Garage ☐ Other ☐  
Entry Location: Center ☒ Sidehall ☐ Other ☐

MAP (Indicate North in circle):

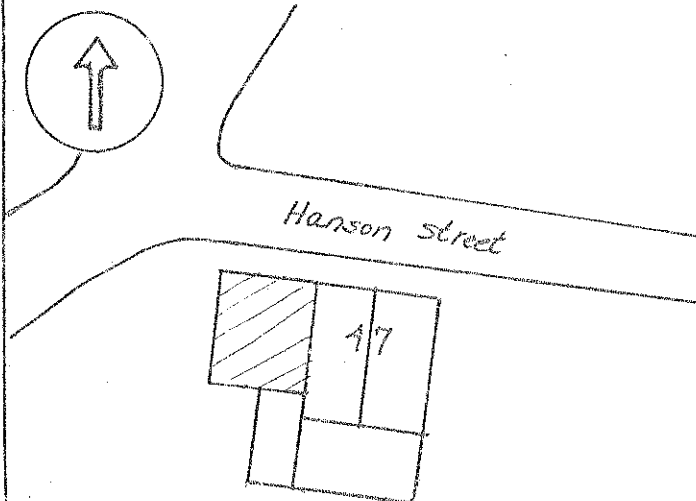

PHOTO

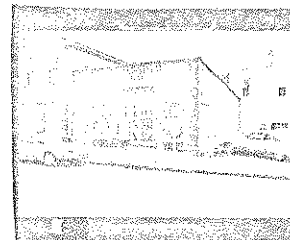

Description of View: Three Quarter

looking south

Photographer: Roger Brevoort

Negative with: S.R.R.C.

Negative File Number: R-81-A4-6

#### ADDITIONAL ARCHITECTURAL AND STRUCTURAL DESCRIPTION:

A contemporary rough-textured wood facade conceals the Victorian identity of this building. The recessed central entry however indicates its initially symmetrical design, and the granite foundation blocks are original decorative elements.

#### RELATED STRUCTURES AND CONTEXT:

With a parking lot to the west, this building begins a late nineteenth century streetscape.

#### BOUNDARY AND ACREAGE DESCRIPTION: 29 X 57

#### REFERENCES:

#### STATEMENT OF SIGNIFICANCE (Evaluation & Historical Associations):

Constructed in 1869 by Charles A.C. Hanson, this building was Rochester's first permanent Post Office, used until 1908.

Prior to erection of this facility, a post office had been established in Barkers Tavern located where the Methodist church now stands sometime before 1812 and 1869. After 1908 the office was in the Hanson McDuffee block until the present post office building was completed in 1913.

SURROUNDING ENVIRONMENT: Open Land ☐ Woodland ☐ Scattered Bldgs ☐ Moderately Built Up ☐  
Densely Built Up ☐ Residential ☐ Commercial ☒ Industrial ☐ Agricultural ☐  
Roadside Strip Development ☐ Other ☐

Recorded By: Roger Brevoort

Date: 11/19/80