

HISTORIC PRESERVATION ASSISTANCE PROJECT

Strafford Rockingham Regional Council

1 Water Street, Exeter, New Hampshire

Phone: (603) 778-0885

TOWN: Rochester	COUNTY: Strafford	UTM: Z19 /E 339825 /N 4796400
SURVEY NUMBER: 34		USGS QUAD: Berwick Quad 15' series
COMMON NAME: The McGurty Building		FUNCTIONAL TYPE: Residential/Commercial
HISTORIC NAME: Unknown		PRESENT USE: Residential
LOCATION: 54 Hanson Street		ARCHITECT/BUILDER: Unknown
OWNER: Frank & Elaine McGurty		CONDITION: Exc. <u>Good</u> Fair ^{XX} Poor Ruins
ADDRESS: 52 Hanson St., Rochester, NH 03867		INTEGRITY: Original Site <u>x</u> Moved (When:)
MAP & PARCEL #: 51/209 120-397		Major alterations & date: Unknown
DATE: C.1890		
SOURCE: Inspection		
STYLE: Italianate		LEVEL/SIGNIFICANCE: Natl State Local <u>x</u>

GENERAL DESCRIPTION: Structural System

1. FOUNDATION: Stone Brick x Concrete Concrete Block
2. WALL STRUCTURE: Wood Frame Post & Beam Ballon Frame x Other 2/2 Sash
Load Bearing Masonry Stone Brick Concrete Block Other
Metal Iron Steel Other
3. WALL COVERING: Clapboard x Wood Shingle Board & Batten Shiplap Aluminum
Novelty Stucco Stone Brick Sheet Metal Asphalt Shingles Vinyl
Asphalt Sheeting Composite Board Other
4. ROOF SHEATHING: Wood Shingle Asphalt Shingle Standing Seam Tim Slate
Pressed Metal Sheet Metal Rolled Asphalt Other
5. ENGINEERING STRUCTURE:
6. OTHER:
of Stories 2 # of Bays 2X3 Approx. Dimensions 20' X 40'
Roof Style: Gable Hip Gambrel Flat x Shed Mansard Jerkinhead
Monitor Sawtooth Other
Appendages: Porches Towers Dormers Bay Windows Ells Chimneys
Wings Cupolas Sheds Garage Other
Entry Location: Center Sidehall Other x

MAP (Indicate North in circle):

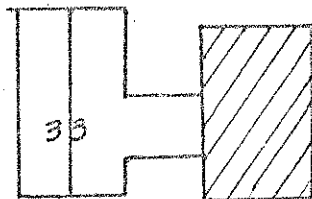
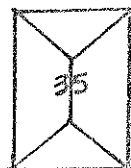

HANSON STREET

PHOTO

Description of View: Three Quarter
facade/northeastPhotographer: Roger Brevoort
Negative with: S.R.R.C.
Negative File Number: R-80-A3-26

ADDITIONAL ARCHITECTURAL AND STRUCTURAL DESCRIPTION:

A clapboarded, 2 story, 2 bay wide Italianate style commercial block, this building is distinguished by a parapet wall with a projecting cornice on the roofline supported in paired brackets.

A smaller cornice supported on smaller single brackets suggests the former presence of a commercial storefront.

The windows contain both 2/2 and 2/1 sash set in plain enframements.

RELATED STRUCTURES AND CONTEXT:

The building is appended to the adjacent house (site 34). It is located within a commercial district.

BOUNDARY AND ACREAGE DESCRIPTION: (LOT SIZE) 26 X 103

REFERENCES:

Richester History Advisory Committee

STATEMENT OF SIGNIFICANCE (Evaluation & Historical Associations):

A simple example of an Italianate commercial block, it contributes to the visual context of the streetscape.

Designed to coordinate with the commercial character of Hanson Street this structure once had a storefront which housed a barber shop. When its connected structure (site #33, The McGurdy House), was converted for use as an inn, this structure was probably built to extend the inn's capacity. Today it is in use as apartments and helps to maintain the historic character of Hanson Street which developed during the day of the railroad.

SURROUNDING ENVIRONMENT: Open Land ☐ Woodland ☐ Scattered Bldgs ☐ Moderately Built Up ☒
Densely Built Up ☐ Residential ☐ Commercial ☒ Industrial ☐ Agricultural ☐
Roadside Strip Development ☐ Other ☐

Recorded By: Roger Brevoort

Date: 11/15/80