



September 7, 2012

Kenneth Ortmann, Director
Department of Planning and Development
City of Rochester
31 Wakefield Street
Rochester, NH 03867

RECEIVED
SEP 14 2012
Planning Dept.

Dear Mr. Ortmann:

As chairman of the Gonic School PTA Playground Committee, I am submitting this Letter of Intent on behalf of the Gonic School PTA. Our organization has raised money to renovate and upgrade the playground behind the school and we are at the point where we expect to install Phase One of our project this November. I have included copies of site maps which show the impacted area is more than 200 feet from the nearest neighbor of the school. You will find the answers to your required questions on the Letter of Intent below. Should you have any questions, please feel free to contact me at any time. I look forward to hearing from you soon.

Sincerely,

Matthew Pappas, Chair
Gonic School PTA Playground Committee

1. The applicant's name, address, telephone number, and email address

Matthew Pappas, Chair
Gonic School PTA
10 Railroad Ave.
Gonic, NH 03839
332-6487 (Gonic School)

Home address:
72 Stillwater Circle
Gonic, NH 03839
pappas@metrocast.net
335-1269 (home)

2. The property owner's name and address (if different)

City of Rochester, School Department
150 Wakefield Street, #8
Rochester, NH 03867

3. Written permission from property owner (if different than applicant) allowing proposed use.

See attached

4. The property location (address, tax map and lot number and Zone).

10 Railroad Ave.
Gonic, NH 03839
Parcel ID: 0139-0034-0000
Zone: A

A committee of the Gonic School PTA * All contributions are 100% tax deductible
10 Railroad Ave. Gonic, NH 03839 603-332-6487 gonicplayground@metrocast.net

SURVEYORS

ENGINEERS

TRANSPORTATION PLANNERS



P.O. Box 249, Rochester, N.H. 03866-0249

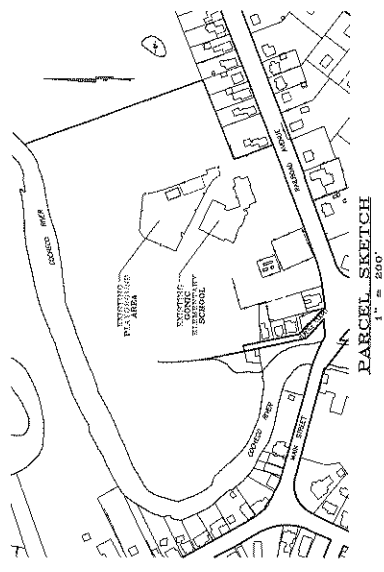

RECEIVED
SEP 14 2012
Planning Dept.

PLAYGROUND SKETCH
RAILROAD AVENUE
ROCHESTER, N.H.
FOR
GONIC SCHOOL
ROCHESTER SCHOOL DEPARTMENT
SCALE: 1"=20' JUNE 2012
GRAPHIC SCALE
1 INCH = 20 FT.

NORWAY PLAINS ASSOCIATES, INC.

SHEET NO.
PLAN NO.
DWG. NO. MTC/GONIC
P.E. NO.



NORWAY PLAINS ASSOCIATES, INC.

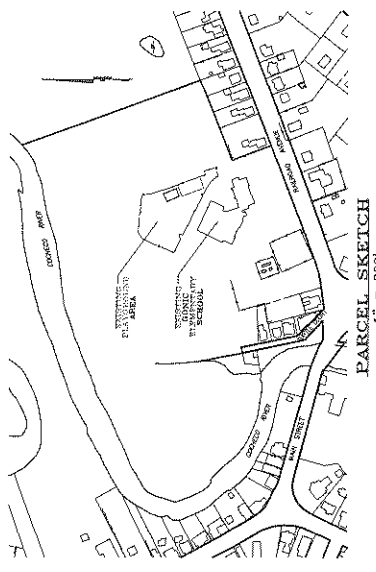
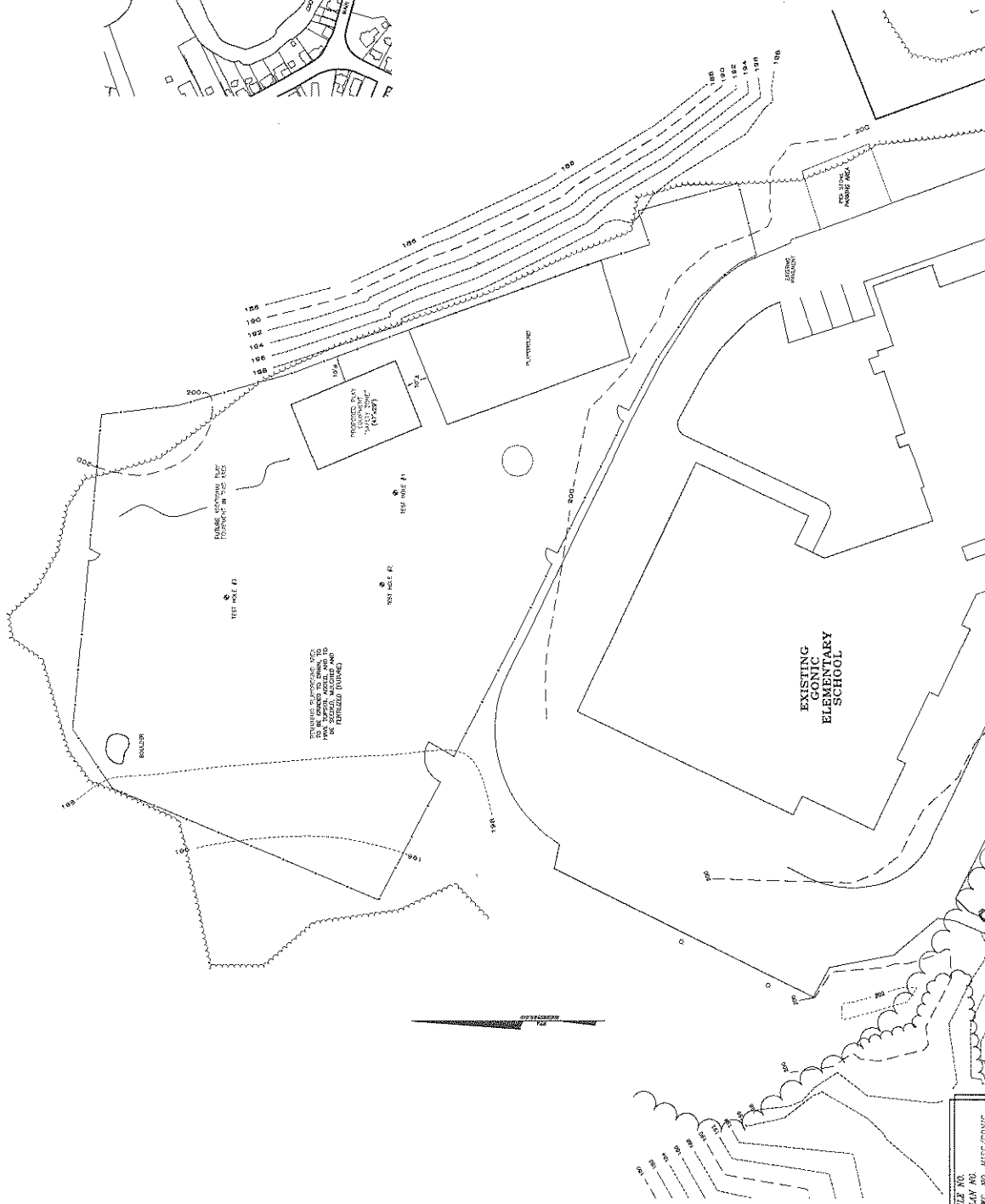

RECEIVED
SEP 14 2012
Planning Dept.

PLAYGROUND SKETCH
RAILROAD AVENUE
ROCHESTER, N.H.
FOR
GONIC SCHOOL
ROCHESTER SCHOOL DEPARTMENT

SCALE: 1"=20' JUNE 2012



