

GRADING AND UTILITY NOTES:

1. THE CONTRACTOR SHALL BE RESPONSIBLE FOR VERIFYING AND DETERMINING THE LOCATION, SIZE AND ELEVATION OF ALL EXISTING UTILITIES SHOWN ON THESE PLANS PRIOR TO THE START OF ANY CONSTRUCTION. THE ENGINEER SHALL BE NOTIFIED IN WRITING OF ANY UTILITIES FOUND INTERFERING WITH THE PROPOSED CONSTRUCTION AND APPROPRIATE REMEDIAL ACTION BE AGREED TO BY THE ENGINEER BEFORE PROCEEDING WITH THE WORK. THE CONTRACTOR SHALL BE RESPONSIBLE TO CONTACT NEW HAMPSHIRE DIG SAFE, AT 1-888-DIG-SAFE, AT LEAST 72 HOURS BEFORE DIGGING.

2. THE CONTRACTOR SHALL BE RESPONSIBLE FOR MAINTAINING ALL EROSION AND SEDIMENT CONTROL DEVICES THROUGHOUT THE DURATION OF THE PROJECT IN ACCORDANCE WITH APPLICABLE NHDES STANDARDS. THE DETAILS PROVIDED SERVE AS A GUIDE ONLY. ALL EROSION CONTROL SHALL BE MAINTAINED AND/OR REPLACED IF DAMAGED.

3. ALL EXCAVATIONS SHALL BE THOROUGHLY SECURED ON A DAILY BASIS BY THE CONTRACTOR AT THE COMPLETION OF CONSTRUCTION OPERATIONS IN THE IMMEDIATE AREA.

4. EROSION AND SEDIMENT CONTROL DURING CONSTRUCTION SHALL BE THE RESPONSIBILITY OF THE CONTRACTOR AND SHALL CONFORM TO ITEM 646 OF THE NH DOT STANDARD SPECIFICATIONS.

5. VERIFY TBM ELEVATIONS PRIOR TO CONSTRUCTION.

6. THE CONTRACTOR SHALL CONTACT ALL UTILITY COMPANIES OWNING UTILITIES, EITHER OVERHEAD OR UNDERGROUND, WITHIN THE CONSTRUCTION AREA. THE PROTECTION OF UTILITIES IS THE RESPONSIBILITY OF THE CONTRACTOR.

7. THE CONTRACTOR SHALL COORDINATE MATERIALS AND INSTALLATION SPECIFICATIONS WITH THE INDIVIDUAL UTILITY AGENCIES/COMPANIES, AND ARRANGE FOR ALL INSPECTIONS.

8. ALL MANHOLES IN PAVEMENT SHALL HAVE RIMS SET TO FINISH GRADE REGARDLESS OF ANY ELEVATIONS OTHERWISE SHOWN.

9. UTILITY CONNECTIONS SHOWN TO PROPOSED BUILDINGS ARE APPROXIMATE AND INTENDED TO ILLUSTRATE FEASIBILITY OF CONSTRUCTING CONNECTIONS. ACTUAL UTILITY CONNECTIONS MAY BE MODIFIED PER UTILITY COMPANY REQUIREMENTS OR DESIGN.

10. ALL UNPAVED AREAS DISTURBED BY THIS PROJECT SHALL BE LOAMED AND SEEDED AND A GOOD STAND OF GRASS ESTABLISHED BEFORE THE COMPLETION OF THIS PROJECT. LOAM SHALL BE PLACED TO A MINIMUM DEPTH OF 6", UNLESS OTHERWISE NOTED.

11. THE GENERAL CONTRACTOR IS RESPONSIBLE FOR CONDUIT AND WIRING TO ALL SIGNS & LIGHTS. WHERE APPLICABLE CONDUIT TO BE A MINIMUM OF 24" BELOW FINISH GRADE.

12. ALL EXISTING CATCH BASINS, MANHOLES, WATER GATE RISERS, GAS GATE RISERS, AND OTHER STRUCTURES LOCATED WITHIN THE LIMITS OF THE PROJECT SHALL BE ADJUSTED TO FINISHED GRADE BY THE CONTRACTOR UNLESS INDICATED OTHERWISE BY THESE PLANS.

13. ALL EXCAVATIONS SHALL COMPLY WITH OSHA AND NEW HAMPSHIRE REQUIREMENTS.

14. PIPES TO BE ABANDONED IN PLACE SHALL BE CAPPED OR GROUTED. THESE LOCATIONS SHALL BE NOTED ON THE RED-LINED PLANS.

15. FLOWS THROUGH STORMWATER CULVERTS AND EXISTING CLOSED DRAINAGE SYSTEMS SHALL BE MAINTAINED DURING CONSTRUCTION.

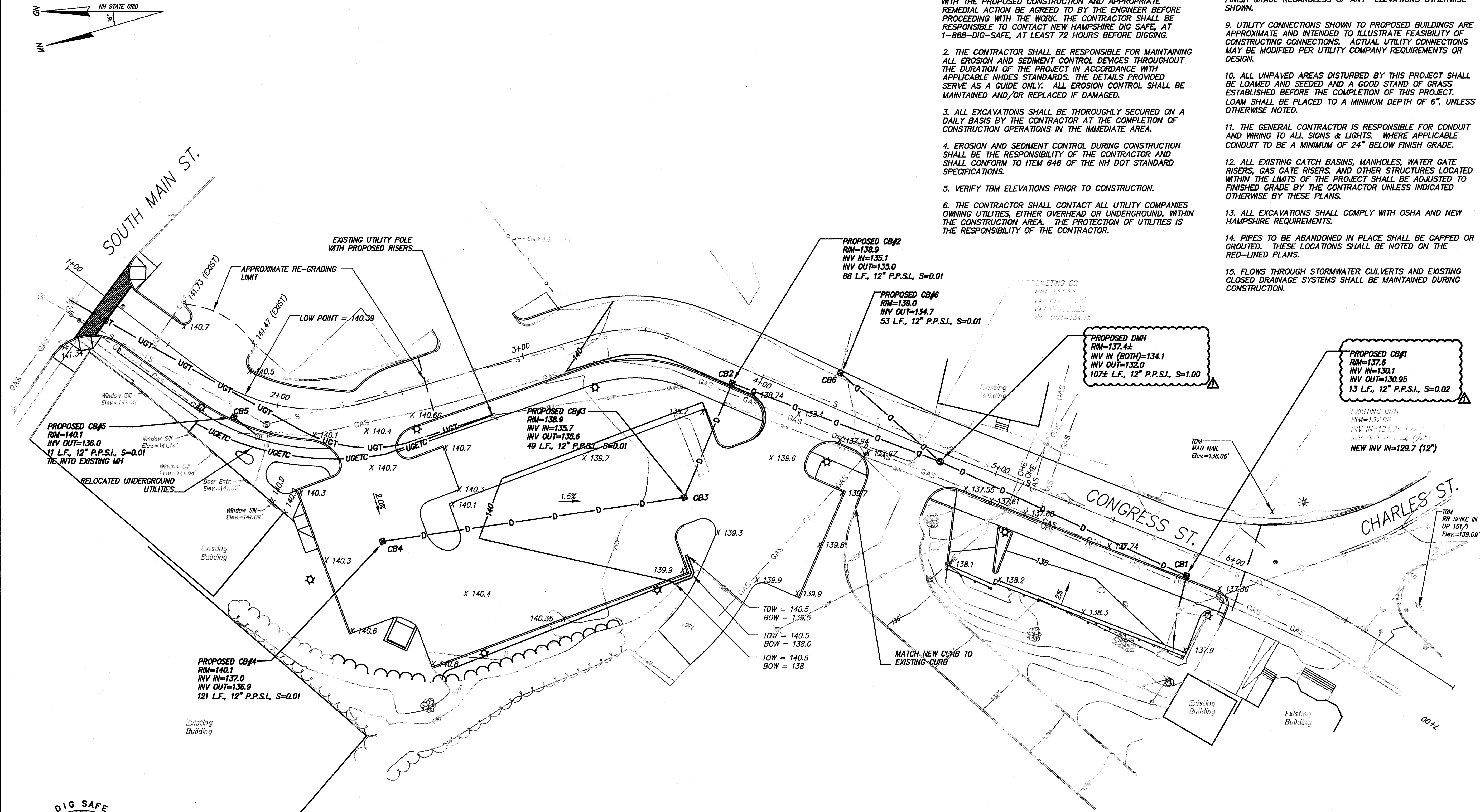

CONTACT DIG SAFE 72 HOURS PRIOR TO CONSTRUCTION

THE LOCATION OF ANY UTILITY INFORMATION SHOWN ON THIS PLAN IS APPROXIMATE. OLD ENG. INC. MAKES NO CLAIM TO THE ACCURACY OR COMPLETENESS OF UTILITIES SHOWN. 72 HOURS PRIOR TO ANY EXCAVATION ON SITE, THE CONTRACTOR SHALL CONTACT DIG-SAFE AT 1-888-DIG-SAFE.

GRAPHIC SCALE



(IN FEET)
1 inch = 20 ft.

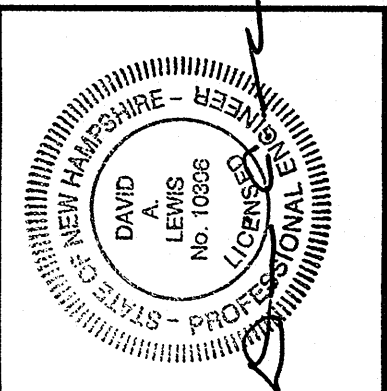

CITY OF ROCHESTER
31 WAKEFIELD STREET
ROCHESTER, NH

CONGRESS STREET
IMPROVEMENTS
ROCHESTER, NEW HAMPSHIRE
GRADING, DRAINAGE &
UTILITY PLAN

SCALE: 1"=20'	JOB NO. 05-0123
DATE: MAY 2007	DWG. C4 5 OF 13